

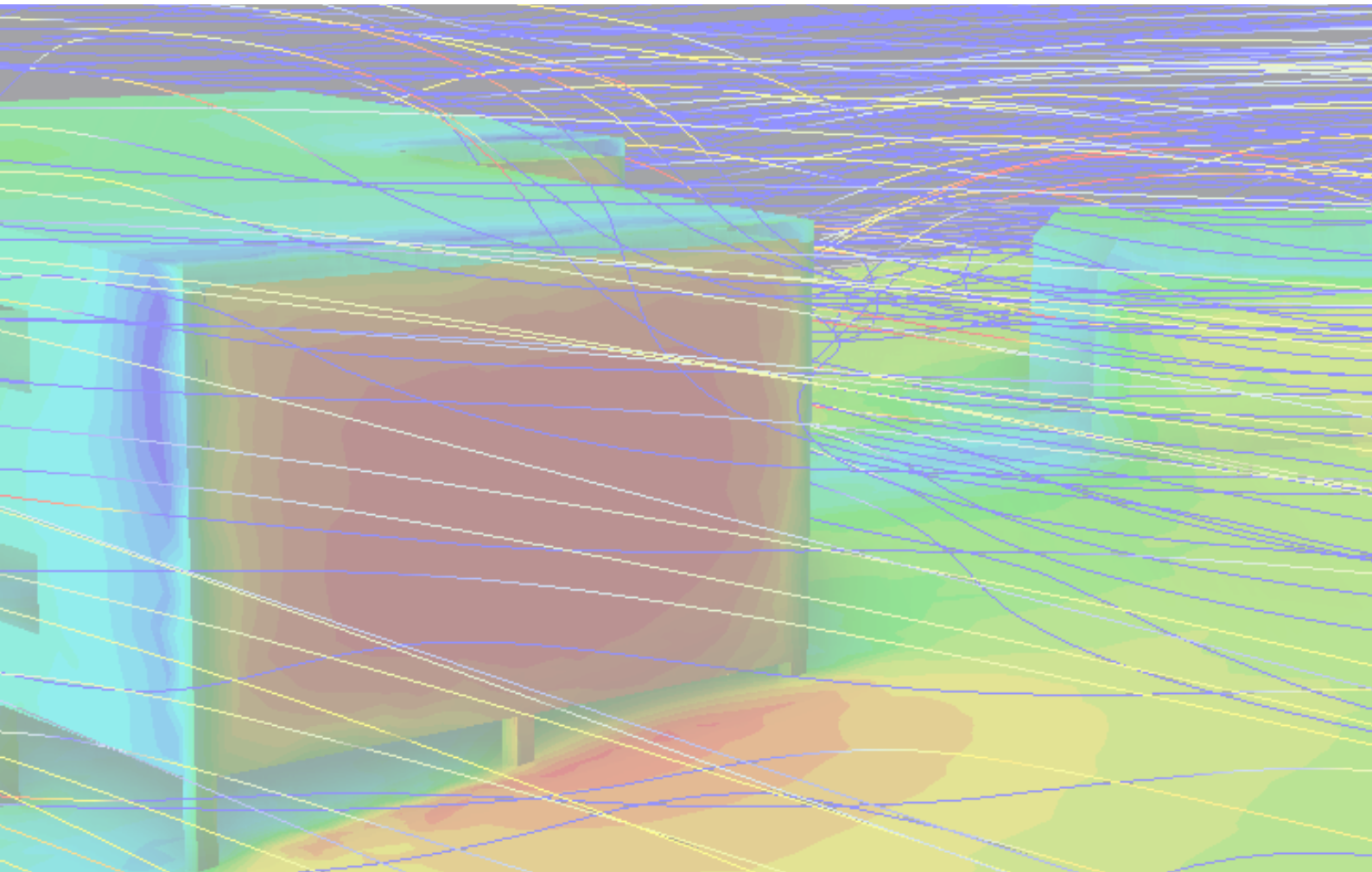

WindCFD

Computational Fluid Dynamics for
Structural Wind Loading

Content Package Instructions



October
2025

Table of Contents

01 Description of Content Packages

02 Download and Install Instructions

03 Additional Notes

Description of Content Packages

Datasets for WindCFD's Context Model Builder is available for download by country / region. These datasets can be relatively large in size, and require a separate download and unpacking from the WindCFD installer.

Datasets will include both DEM and Building Footprint data.

Downloads available at:

<https://bimwerxfea.com/WindCFD.html>

DEM (Digital Elevation Model) data obtained and processed from the original sources: NASA JPL (2021). <i>NASADEM Merged DEM Global 1 arc second V001</i>. Distributed by OpenTopography. <https://doi.org/10.5069/G93T9FD9>. Accessed 2025-10-02

Building Footprint data obtained and processed from <https://github.com/microsoft/GlobalMLBuildingFootprints>

Download and Install Instructions

Download the relevant dataset for your Country / Region, and extract the contents to a desired location, for example:

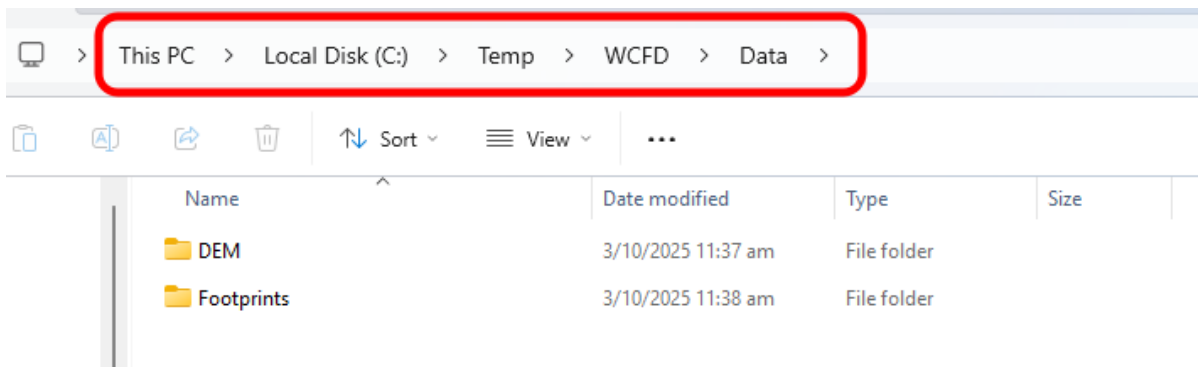

Start WindCFD, and set the 2 locations for SRTM Data folder, and Build Footprint Data folder, for example:

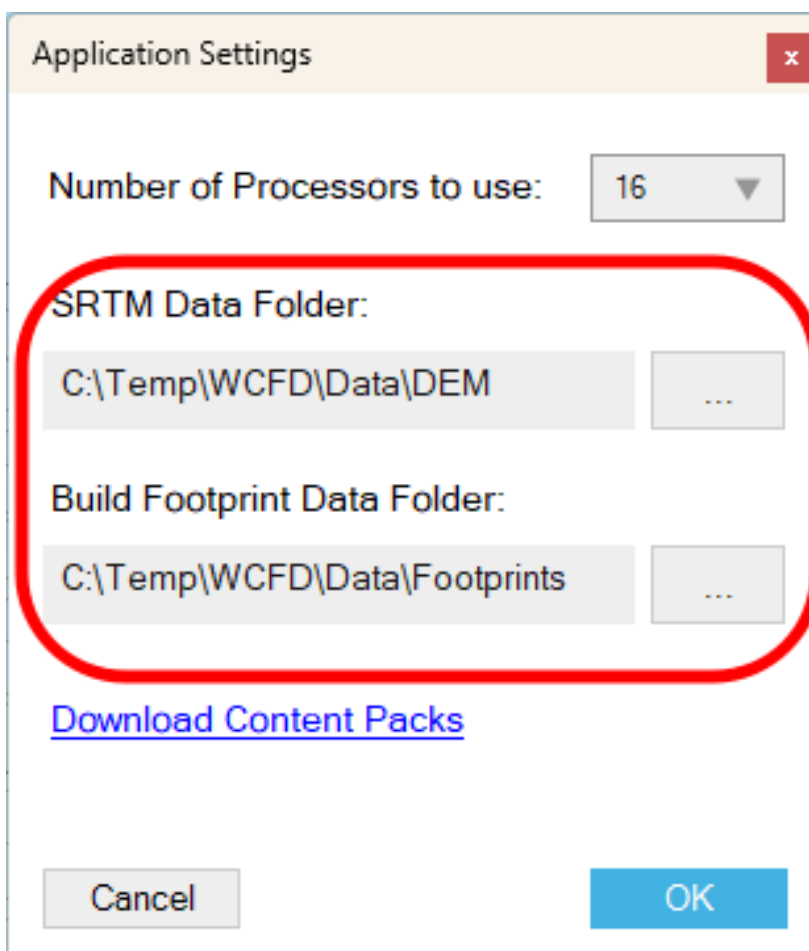

Additional Notes

- Restart WindCFD after setting the dataset folders
- Multiple Country / Region datasets may be combined, make sure to place country folders for DEM under the same folder, and also for Footprints
- If your Country or Region is not available yet, please log a request at info@bimwerx.nz



**Dr Julian
Lee**

Subject Matter
Expert



**Chris
Vorster**

Technology &
Development



**Peter
McMenamin**

Business &
Strategy



SCAN ME

Let's Work Together ↗

Contact Us



+64 21 114 0942



chris@bimwerx.nz



bimwerx.nz
bimwerxfea.com